



DNH

HEAD OFFICE, NORWAY
DNH AS

Phone..... + 47 35 98 56 00
E-mail..... dnh@dnh.no
Web-Site..... www.dnh.no

ENGLAND

DNH WW Ltd

Phone..... + 44 1908 275 000
Fax..... + 44 1908 275 100
E-mail..... dnh@dnh.co.uk

GERMANY

DNH GmbH

Phone... + 49 040 6569 30-0
Fax..... + 49 040 6569 30-30
E-mail..... dnh@dnh.de

DSP-15(T)

USA

DNH Speakers Inc

Phone..... + 1 484 494 5790
Fax..... + 1 484 494 5793
E-mail..... dnh@dnhspeakers.com

ISO 9001 CERTIFIED

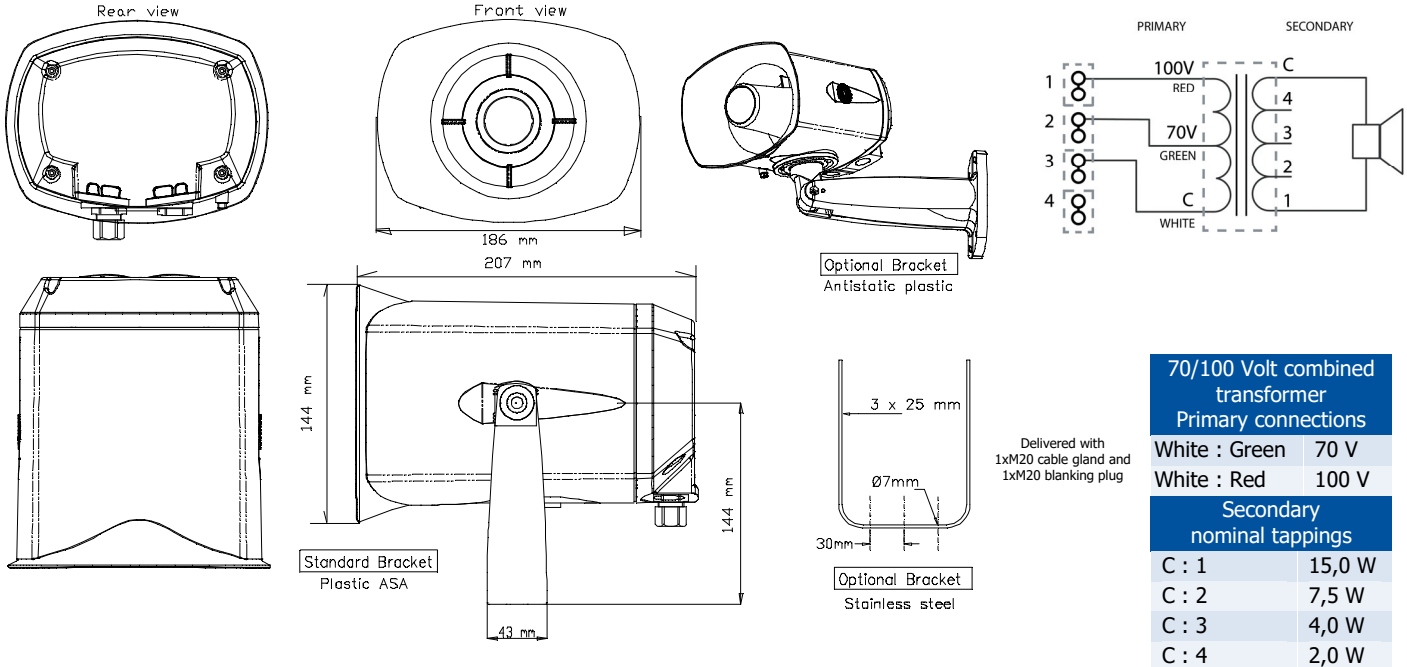

Sound pressure levels at 1W/1m (MP-28-54)
SPL vs Freq

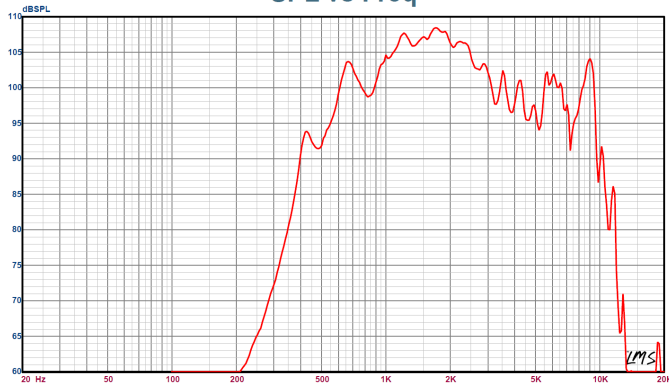

Specifications

| | |
|--------------------------------|----------------------------|
| Material / Color | ASA / RAL 7035 |
| Mounting | Bracket |
| Termination | screw terminal |
| Weight w/transformer | 1,8 kg |
| IP-rating | 67 |
| Max. / min. amb. temp | 90°C / -50°C |
| Rated power | 15W |
| SPL 1W/1m | 106 dB |
| SPL rated power | 117 dB |
| Effective freq. range | 550 – 9500 Hz |
| Dispersion (-6dB) 1kHz / 4kHz | 140° / 33° |
| Directivity factor, Q1kHz/4kHz | 1,8 / 7,6 |
| Options | Impedances, colors, labels |

Installation, Operation and Maintenance Procedures

- Remove lid by four screws, lead cable through the cable gland and connect to the terminal. (White:Green 70V or White:Red 100V)
- Select required tapping on the transformer.
- Check that the gasket is fitted correctly on to the lid. Do not use any lubricants on the gasket.
- Screw lid back into place by four screws with a torque of 1.3 – 1.8 Nm to assure the IP rating.
- To change the position of the loudspeaker, please adjust the standard U- bracket (by loosening / tightening the screws) as required.
- DSP-15(T) can be supplied with three different bracket systems, according to customer requirements.
- For optimum performance, always use the correct voltage / power and operate within the frequency limits as stated.
- Do not open loudspeaker when energized.
- This loudspeaker is supplied with two years warranty against defective workmanship.

DNH reserves the right to alter specifications without notice.

